

STANDARD Series

BASIC COMPONENTS

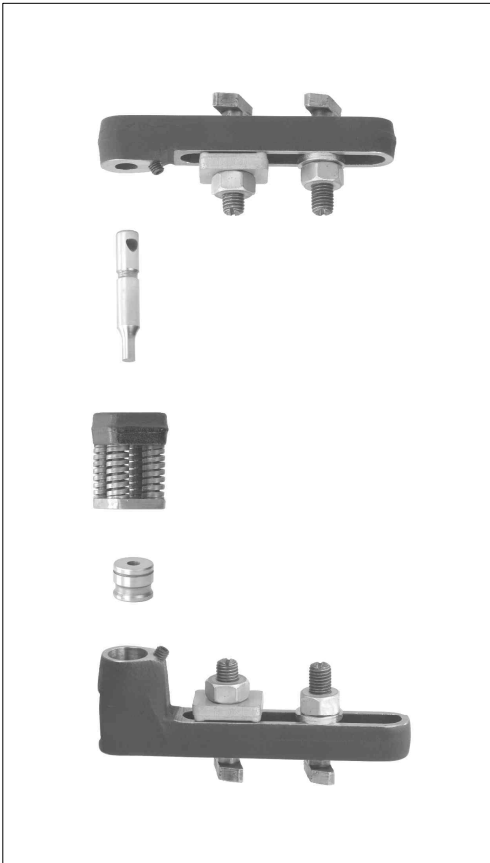

PUNCH RETAINERS: SERIES - 50 75 100 150 225 300 400
Up to .125" (3.2 mm) max mat'l thickness use PR or PRS (flat or slot keyed). From .125" to .25" (6.4 mm) max mat'l thickness use PRX or PRSX (flat or slot keyed)

PUNCHES: SERIES - 50 75 100 150 225 300 400
PU or PUS (flat or slot keyed)

STRIPPERS: SERIES - 50 75 100 150 225 300 400
Up to .125" (3.2 mm) max mat'l thickness use PS, S, UMSC
From .125" to .25" (6.4 mm) max mat'l thickness use PSX (PSX not available in series 225 - 400), SX, UMSXT.

DIE BUSHINGS: SERIES - 50 75 100 150 225 300 400
DBU or DBUS (flat or slot keyed)

DIE RETAINERS: SERIES - 50 75 100 150 225 300 400
DR or DRS (flat or slot keyed)

Punch Profiles

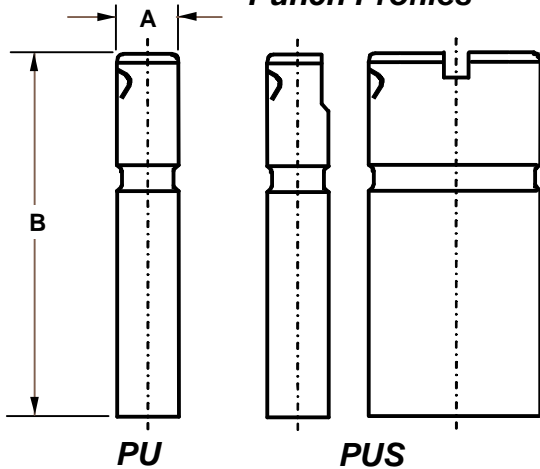

Bushing Profiles

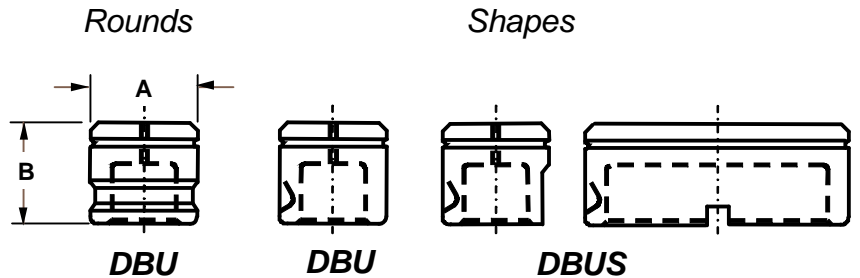

CATALOG NUMBER	A	B
PU-50	.500"	3.162"
PUS-50	(12.7 mm)	(80.31 mm)
PU-75	.750"	3.162"
PUS-75	(19.5 mm)	(80.31 mm)
PU-100	1.000"	3.162"
PUS-100	(25.4 mm)	(80.31 mm)
PU-150	1.500"	3.162"
PUS-150	(38.1 mm)	(80.31 mm)
PU-225	2.250"	3.000"
PUS-225	(57.15 mm)	(76.2 mm)
PU-300	3.000"	3.000"
PUS-300	(76.2 mm)	(76.2 mm)
PU-400	4.000"	3.000"
PUS-400	(101.6 mm)	(76.2 mm)

CATALOG NUMBER	A	B
DBU-50	.875"	.812"
DBUS-50	(22.22 mm)	(20.62 mm)
DBU-75	1.500"	.812"
DBUS-75	(38.1 mm)	(20.62 mm)
DBU-100	1.750"	.812"
DBUS-100	(44.45 mm)	(20.62 mm)
DBU-150	2.250"	.812"
DBUS-150	(57.15 mm)	(20.62 mm)
DBU-225	3.250"	.812"
DBUS-225	(82.55 mm)	(20.62 mm)
DBU-300	4.000"	.812"
DBUS-300	(101.6 mm)	(20.62 mm)
DBU-400	5.750"	.812"
DBUS-400	(146.05 mm)	(20.62 mm)